

Double delight



The home captures external views from all internal living areas.



○ PENELOPE THOMAS

The Rural Building Company embraced a timeless aesthetic with a heavy dose of country charm for its Twin View display home, situated at Parkerville.

The Rural Building Company Principal Designer Robert Kirkovski told *New Homes* the multi-faceted design was an exciting take on a traditional home.

“It truly is the home that looks good from all angles, with bush poles, expansive outdoor covered areas and an attractive external elevation,” he said.

“The free-form living arrangement is configured to suit many lifestyles, with high, feature raked ceilings and access to two separate and distinct outdoor living areas.”

The single-storey home features independent living zones, with four generously sized bedrooms. The layout offers ultimate versatility and feels both connected and independent.

A central meeting point for family and friends connects at the centre of the home and includes the sitting, living, dining and kitchen areas.

“This impressive design can be enjoyed all year round,” Mr

Kirkovski said. “The home has tremendous exposure to external areas and captures views from all internal living areas.”

Walls of glass connect the home to the outdoors and flood the interior with plenty of natural light, offering an element of organic cosiness through interaction with the surrounding natural landscape.

The kitchen is an integral part of the internal space, with views not only to the front, but to the rear of the home. Complete with quality appliances, the area is an ideal for preparing meals and looks out to the wider surrounds.

A generous scullery accompanies the kitchen, coupled with the laundry and connecting to the carport for easy access.

The private master suite is a haven containing an outdoor porch with large sliding doors and a spacious dressing room, as well as a luxurious ensuite with double vanities and a freestanding bath.

Flanked by nature, the display feels contemporary and pared back in an understated and charming way.

The Twin View display home is open for viewing Mondays and Wednesdays from 2-5pm and Saturdays and Sundays from 1-5pm.



THE TWIN VIEW

4 2

ADDRESS 9 Duncombe Drive, Parkerville

PRICE From \$339,145 (metropolitan pricing)

BUILDER The Rural Building Company

CONTACT 1800 643 800

www.ruralbuilding.com.au

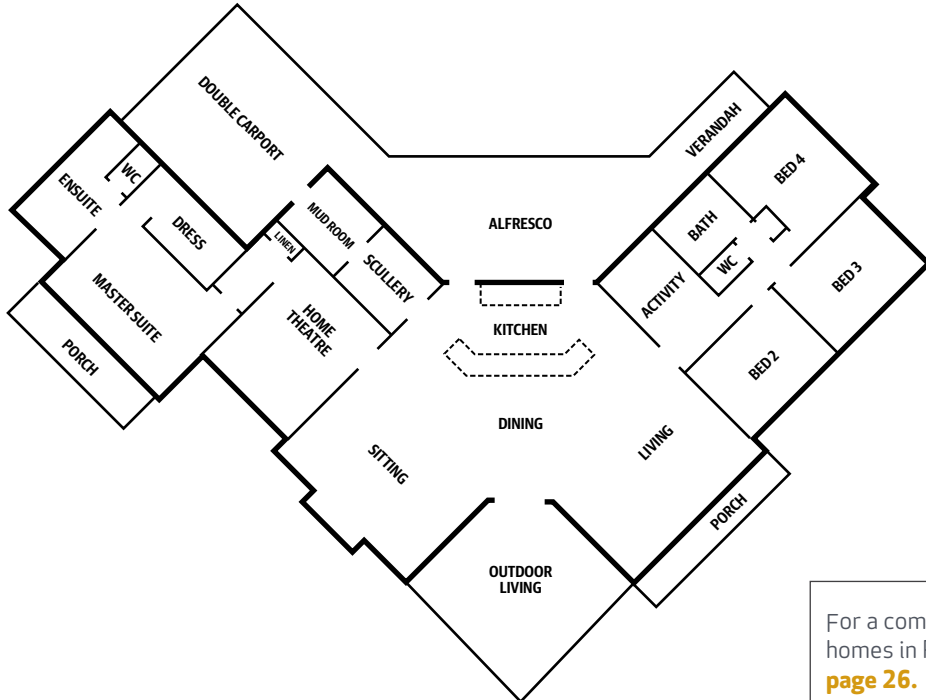

For a comprehensive list of display homes in Perth, see our guide on [page 26](#).