



Australian by nature

BY CHLOE VELLINGA

Showcasing wraparound verandahs, rugged timber bush poles and a spacious alfresco which overlooks the great outdoors, The Karridale Retreat is an excellent example of modern Australiana architecture.

Showcasing all the trademarks of The Rural Building Company homes, such as large informal open-plan living zones, soaring raked ceilings, Colorbond roofing and a

mixture of weatherboard and rendered exteriors, this three-bedroom, two-bathroom display exudes grand country-style living at every glance.

The Rural Building Company Principal Designer Robert Kirkovski said the home oozed traditional rural flavour with a modern edge.

"This is an awesome representation of a home that works fabulously within the Western Australian landscape," he said.

"It's a home that celebrates the environment and showcases how that environment can contribute to a lifestyle to be enjoyed by all the family."

Upon entry, guests are instantly greeted to the home's core open-plan setting.

Each zone flows flawlessly, with a summer room and a winter room carefully positioned to maximise the delights of each season, with a stunning two-sided fireplace taking centre stage.

"A home's spaces can feel differently depending on the times of the day and

This house is an awesome representation of a home that works fabulously within the Western Australian landscape.



even the times of the year," Mr Kirkovski said.

"The spaces can be used as unique areas that have differing qualities dependent on the seasons. Having the grand central core also enables for massive sight lines to external views both at the front and towards the rear."

The expansive kitchen and scullery combination sports an informal arrangement, allowing homeowners to move freely from one zone to the next without any formal barriers.

"The kitchen flows and wraps in on itself," Mr Kirkovski said.

"The main kitchen functions are situated towards the free-form living areas, with the scullery and pantry easily accessible but still concealed and out of sight."

Rounding out the 250sqm floor plan is a den come home theatre space, an activity zone and a master suite which dazzles with relaxed, resort-style living qualities.

"The parents' retreat is positioned so as to

maximise any views the home may have," Mr Kirkovski said.

"The front verandah wraps around the home, taking in the master suite which has direct access to the outside."

The Karridale Retreat is located in Aveley and is open for viewing on Mondays and Wednesdays from 2-5pm and Saturdays and Sundays from 1-5pm.



THE KARRIDALE RETREAT

3 2

ADDRESS 120 Windermere Boulevard, Aveley

PRICE From \$341,256 (Perth metropolitan)

BUILDER The Rural Building Company

CONTACT 1800 643 800

www.ruralbuilding.com.au

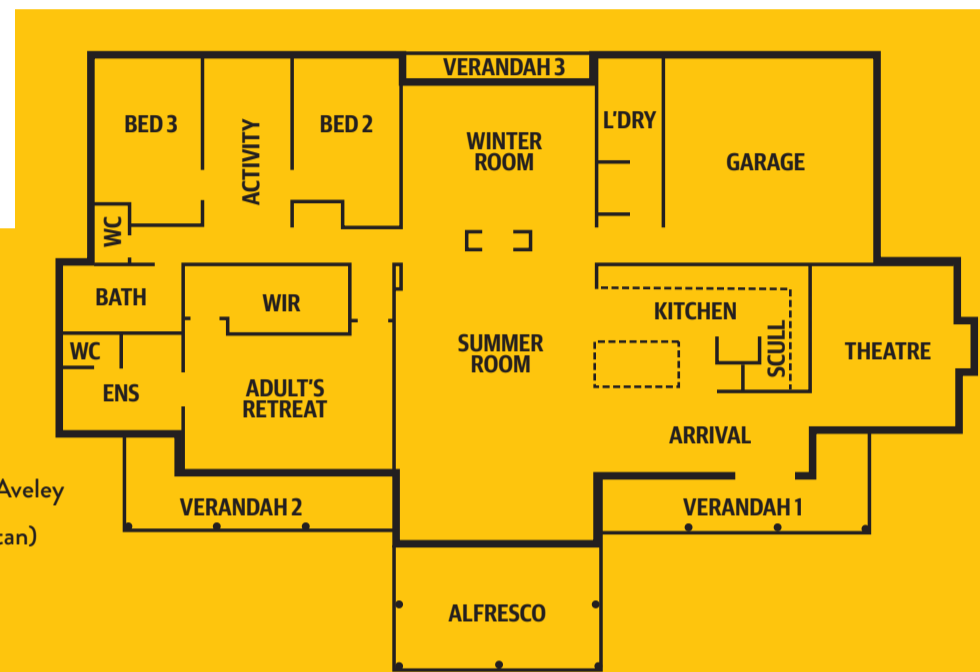

HALF PAGE HORIZONTAL
175x256

RBWA

HALF PAGE HORIZONTAL
175x256

AFFINITY/HARMONY