

An Aussie favourite

BY CHLOE VELLINGA

Just like the classic John Williamson song *Home Among the Gumtrees* it is easy to imagine this home being built amongst our great Western Australian landscape.

Ingeniously named The Karri Creek after the South West's beautiful Karri Forrest, this home speaks volumes of our relaxed Australian lifestyle and our love for the great outdoors.

Generous in size, this three-bedroom, two-bathroom display can fit on many different block configurations, giving the homeowner plenty of flexibility when building and designing their new dream home.

Countless feature windows, luscious raked ceilings, bush feature poles and a crisp white facade leave you with a home that is sure to stand the test of time.

Rural Building Company Design Manager Robert Kirkovski said although this display was simple and refined in terms of layout, like many of the company's designs, it didn't conform to convention.

"The home is suited to people who enjoy a home with character and personality – a home that contributes to them leading a relaxed lifestyle," he said.

"This home design has been tried and tested over the years with tremendous success.

"One reason is because of it's flexible design which can be altered to suit many differing lot configurations."



In the heart of the home lies an exquisite timber and stone fireplace and spacious open-plan living area, perfect for the whole family to relax, unwind and entertain with family and friends all year round.

Add countless feature windows which let in plenty of natural light, luscious raked ceilings, bush feature poles and a crisp white weatherboard and brick exterior, and you are left with a home that is sure to stand the test of time.

The overall facade exudes a contemporary spin on the Rural Building Company's tribute to the traditional Australian home.

"The facade has classic traditional symmetry with a welcoming approach of the outdoors," Mr Kirkovski said.

"It draws the views from outside so they become part of the everyday lifestyle that people can enjoy.

"With plenty of glass and unique in design, these homes are perfect for blocks in the country where you are nestled into the hillside and want to take advantage of a panoramic view of the scenery."

The display is open Mondays and Wednesdays from 2-5pm and Saturdays and Sundays from 1.5pm.

THE KARRI CREEK TRADITIONAL

3 2

ADDRESS Mauravillo Estate
24 Wanju Drive, Wundowie

PRICE \$378,559

BUILDER Rural Building Company

CONTACT 1800 643 800
www.ruralbuilding.com.au

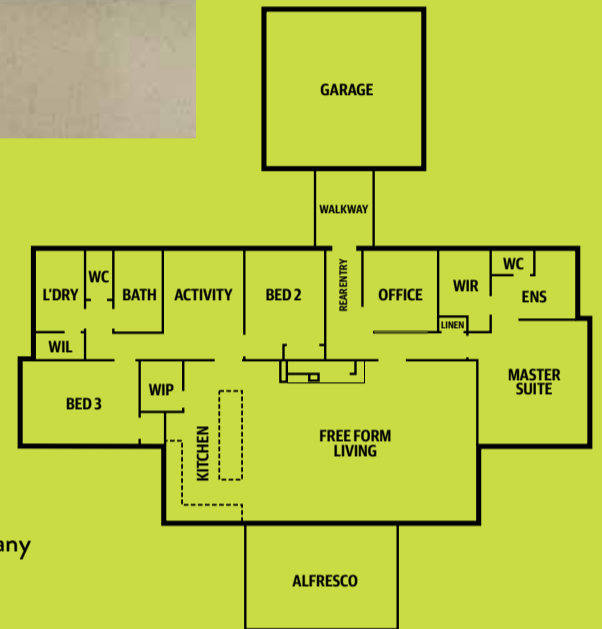

QUATER PAGE AD
Artwork Size: 175 x 126